

Model: SHF 3 & SHF 10

3D Rendered View

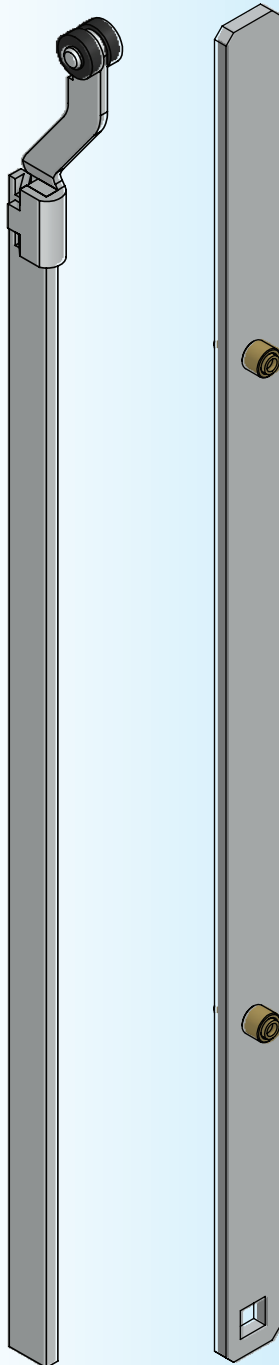

SHF 03-5B-1

SHF 10

SHF 03

AVAILABLE IN STAINLESS STEEL ON REQUEST

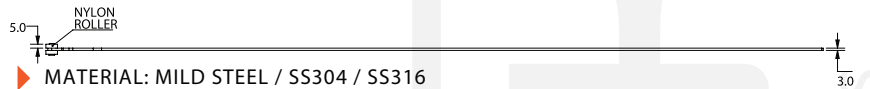
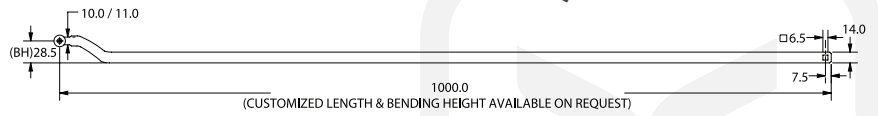

▶ MATERIAL: MILD STEEL / SS304 / SS316

▶ FINISH: ZINC WITH TRIVALENT BLUE PLATING / BUFFING POLISHING

SHF 03 5MM

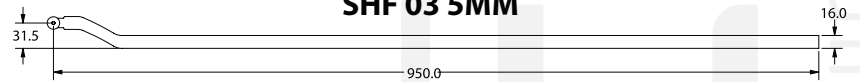

▶ MATERIAL: MILD STEEL

▶ FINISH: ZINC WITH TRIVALENT BLUE PLATING

SHF 03-5B-1

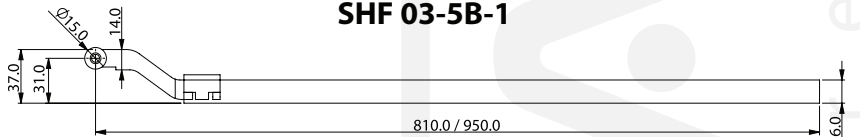

▶ MATERIAL: MILD STEEL

▶ FINISH: ZINC WITH TRIVALENT BLUE PLATING

SHF-10B-1

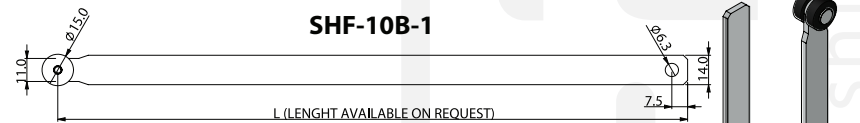

SHF-10B

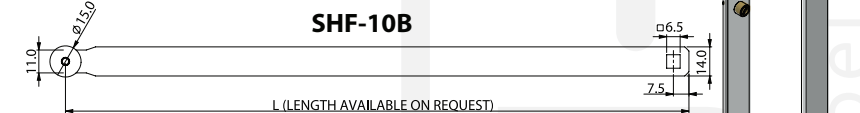

SHF-10

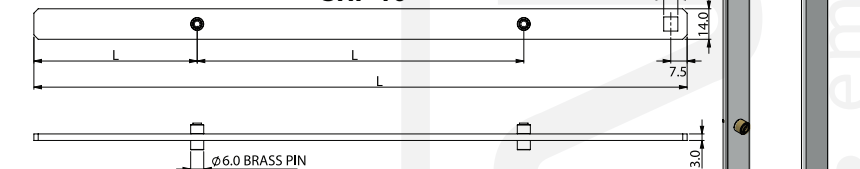

(L) LENGTH AVAILABLE ON REQUEST

▶ MATERIAL: MILD STEEL & SS 304 / SS 316

▶ FINISH: ZINC WITH TRIVALENT BLUE PLATING & BUFFING POLISHING

**BENDING HEIGHT (BH) & LENGTH (L)
AVAILABLE ON REQUEST**

**SS 304/316 AVAILABLE ON REQUEST
MOQ 100 Nos**