

N-RACK

embellishing your enclosures...

**Industrial
Hardware** | embellishing
your
enclosures...**Model: MSH 01****RL****Photo View****3D Rendered View**

- ▶ MATERIAL: ALUMINIUM ALLOY BODY, LOCK COVER, ZINC PLATING SHAFT, CAM, MOUNTING PLATE
- ▶ FINISH: GRAY / BLACK POWDER COATED
- ▶ PANEL THICKNESS: 1-4.5MM
- ▶ REMARK: PADLOCK DEVICE, CAM CUTOUT 10X10

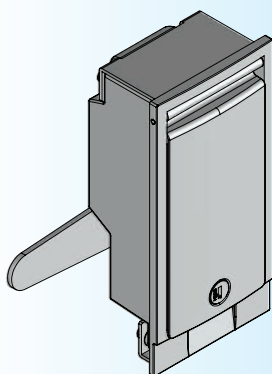
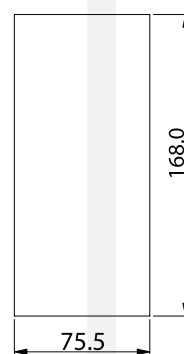
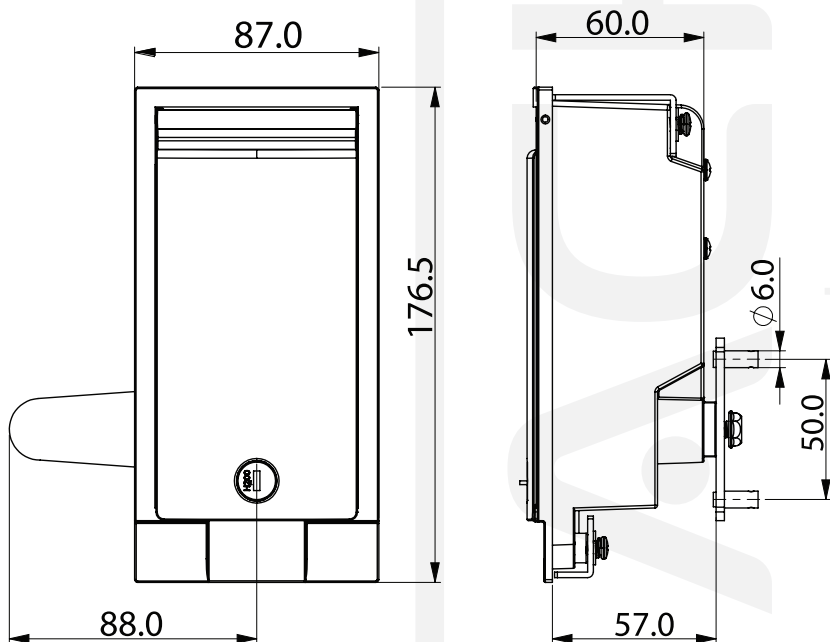

CUT-OUT